

40813 Parts List

Side Tube Assembly
Item -012
Qty 1

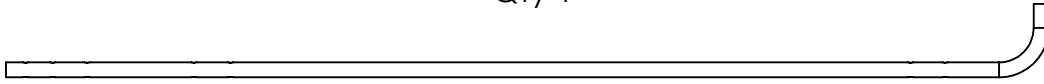

Bracket Plate
Item -015
QTY 1

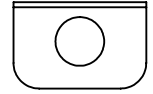

Support Angle
Item -014
QTY 1

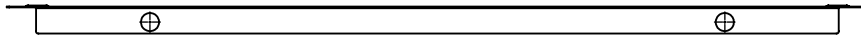

Clamp Pads
Item -034
QTY 2

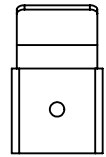

Lock Box Assembly
Item -002
QTY 1

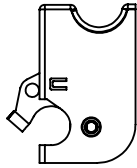

Pad Bracket
Item -026
QTY 1

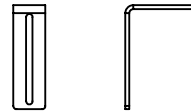

Handle
Item -002
QTY 1

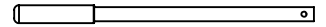

Tube Assembly
Item -016
QTY 1

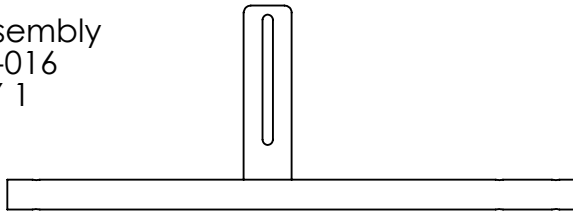

E-6000
QTY 1

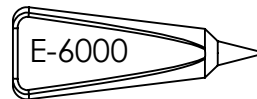

40813 Hardware List

Tools Needed

8' Tape Measure
1/2 Socket
9/16 Socket

1/2 End Wrench
9/16 End Wrench
Hammer

Component Pack

Qty 2
Flange Bushing
Item -013

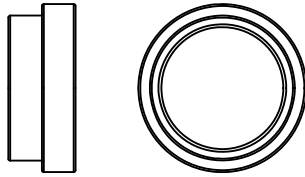

Qty 2
5/16 ID Nylon Washer
Item -038



Hardware Pack

(a)
Qty 1 -
3/8-16 x 1 Carriage Bolt

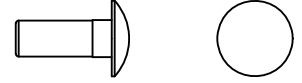

(c)
Qty 3 -
3/8-16 Nylock Nut



(b)
Qty 3 -
3/8 Flat Washer



(k)
Qty 8 -
5/16 Flat Washer



(g)
Qty 1 -
5/16 x 2 3/4 Hex Bolt

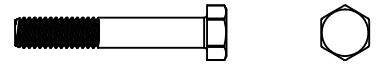

(h)
Qty 1 -
5/16 Nylock Nut



(v)
Qty + -
5/16 x 1 3/4
Carriage Bolt

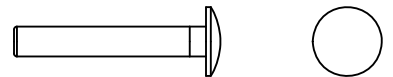

(w)
Qty 2 -
3/8-16 x 3/4 Carriage Bolt

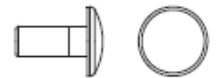

(z)
Qty 1 -
5/16 Contour Washer



KARGO MASTER®

For TECHNICAL SUPPORT Call: 800-343-7486 Monday - Friday 8:00 A.M to 4:30 P.M. (PST)

STEP 1

Install side tube (-012) per **[DIAGRAM 1b]** using 4 each carriage bolts (v), 4 each 5/16 flat washers (k) and 4 each 5/16 nylock nuts (h). Run a bead of E6000 sealer (supplied) around the head of the bolt. This will prevent possible corrosion of the tube I.D.

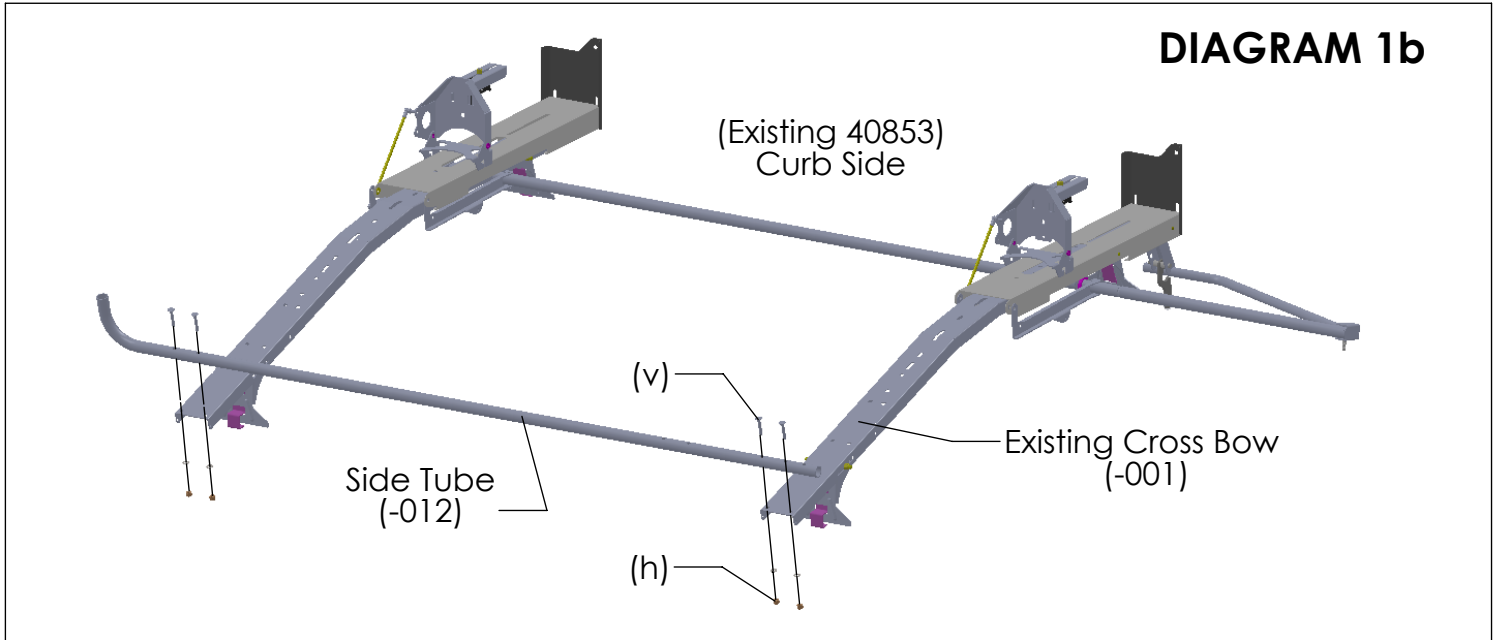

STEP 2

Install support angle (-014) per **[DIAGRAM 1c]** using 2 each 3/8 x 1 carriage bolts (a), 2 each 3/8 flat washers and 2 each 3/8 nylock nuts (c). Install into third square hole from the end of cross bow (-001).

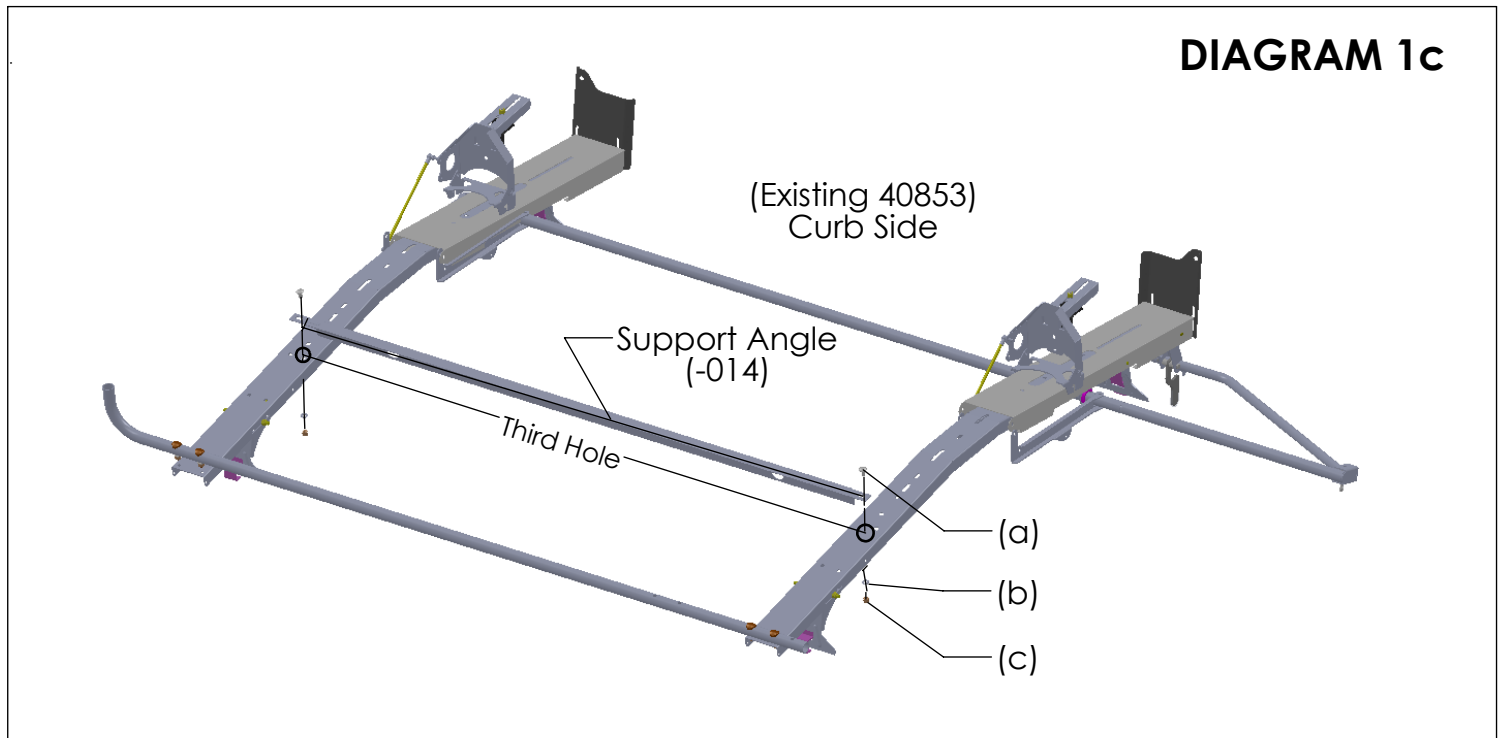

STEP 3

Next, insert bushing (-013) into support angle (-014) flange side in per **[DIAGRAM 2a]**. Next, insert bushing (-013) into bracket plate (-015) as shown in **[DIAGRAM 2b]**.

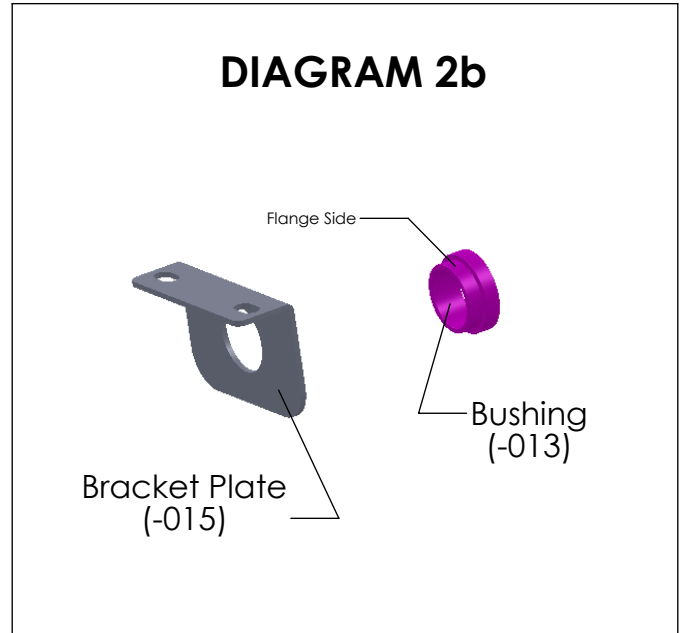
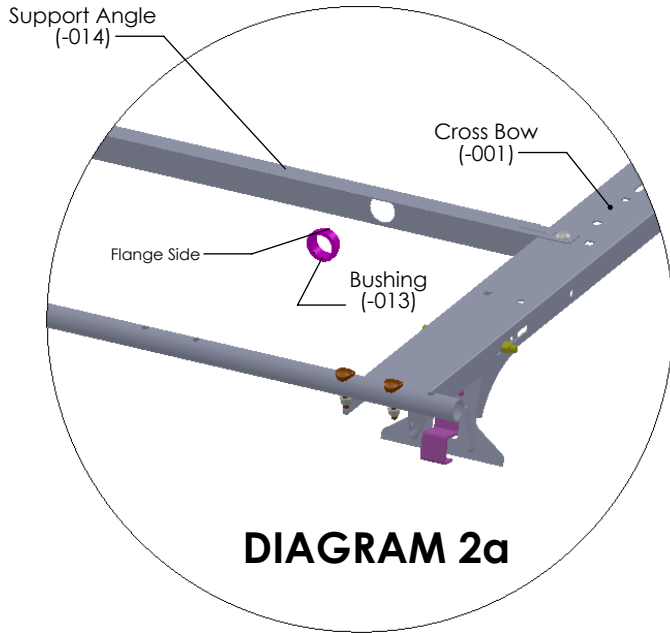

STEP 4

Install bracket plate (-015) with the flange facing outward onto tube assembly (-016) as shown.

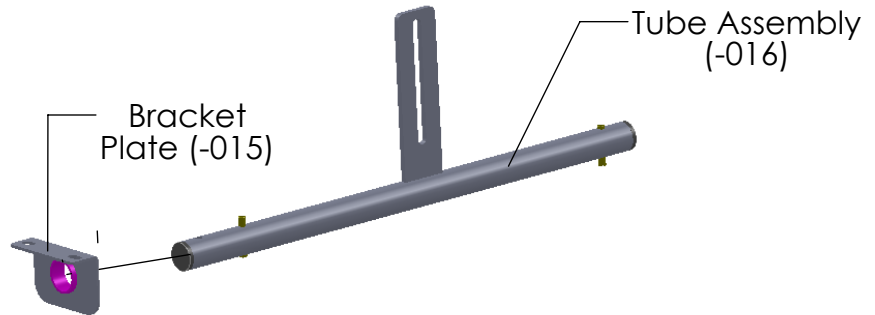

STEP 5

Now install the end of tube assembly (-016) into the bushing on the support angle (-014). Match up the holes in the bracket plate (-015) to the holes in the side tube (-012) and insert 2 each carriage bolts (v), 2 each 5/16 flat washers (k) and 2 each 5/16 nylock nuts (h). Run a bead around heads of bolts with E6000.

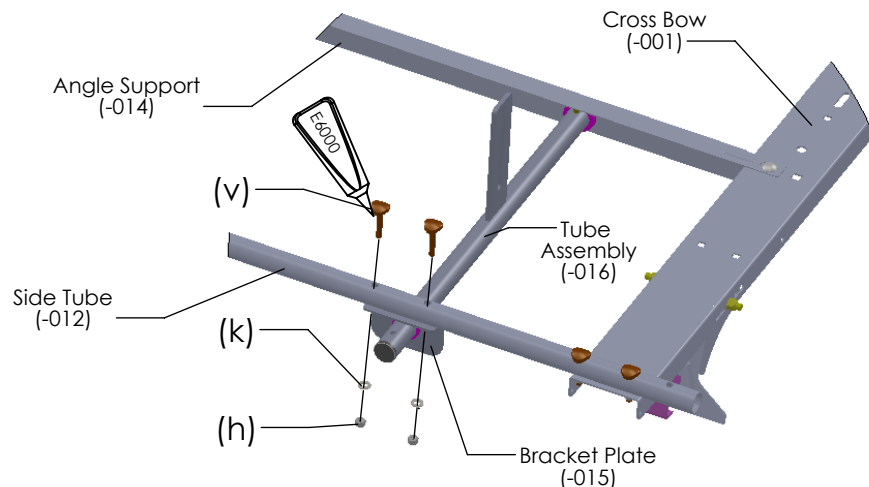

STEP 6

Next, install handle (-002) to the end of tube assembly (-016) using 1 each 5/16 x 2 3/4 hex bolt (g), 2 each nylon washers (-038), 2 each 5/16 flat washers (k), 1 each 5/16 nylock nut (h). Note: insert washers (-038) over and under handle tube (-002) per **[DIAGRAM 3]**. Tighten so handle rotates freely.

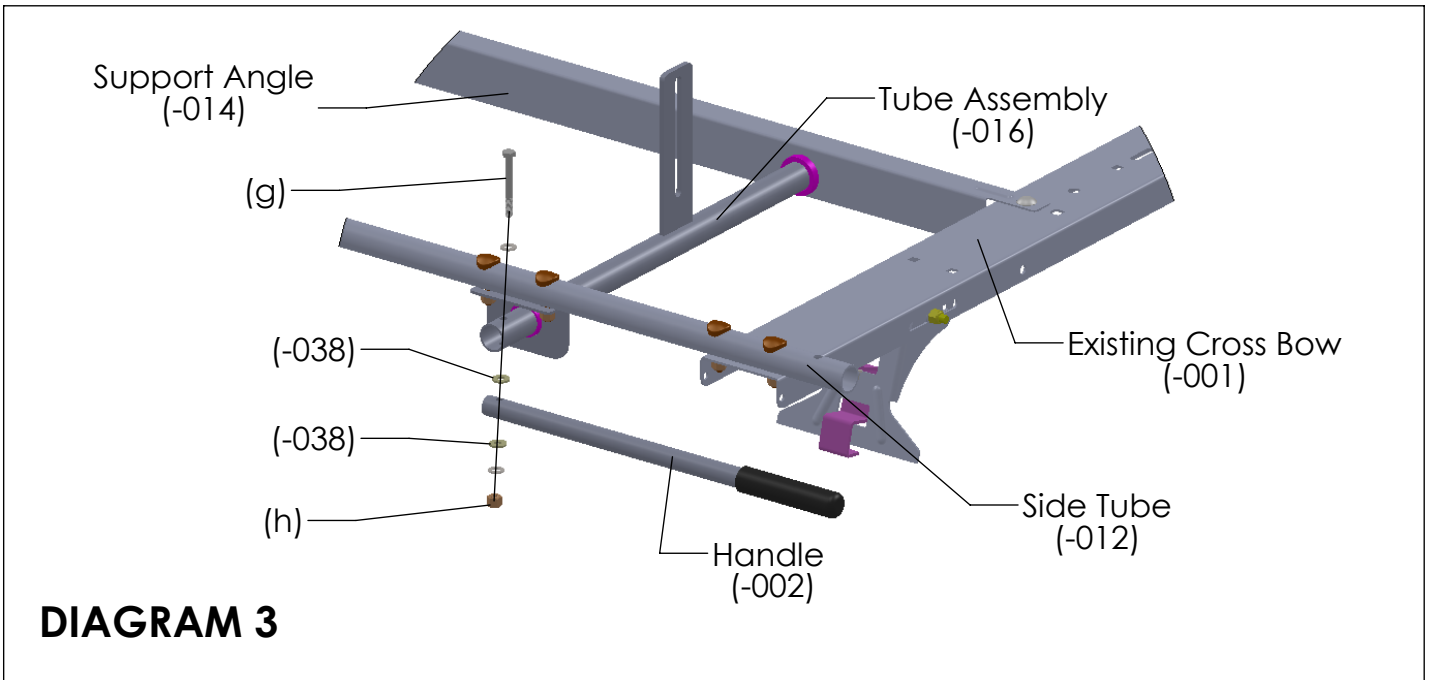

STEP 7

Install the lock box assembly (-002) to the end of the side tube (-012) per **[DIAGRAM 4]** Using 1 each 5/16 x 1 3/4 carriage bolt (v), 1 each 5/16 washer (k), 1 each 5/16 nylock nut (h). Run a bead around head of bolt with E6000 as shown.

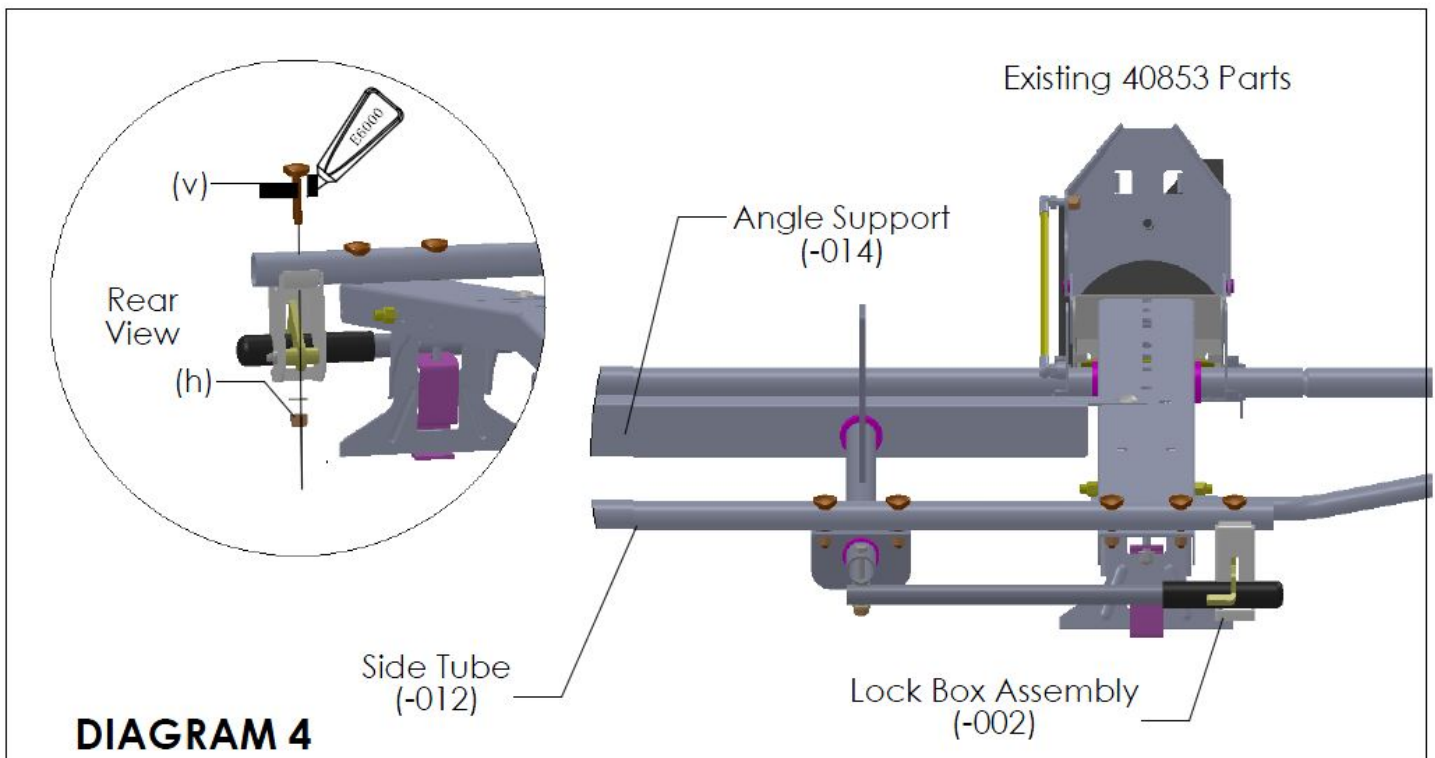

STEP 8

Install pad bracket (-026) using 1 each 3/8 x 1 carriage bolt (m), 1 each 3/8 flat washer (b), 1 each 3/8 nylock nut (c) shown in **[DIAGRAM 7]**. Do not tighten for later adjustment. Now install the clamp pads (-034) to pad bracket (-026) and tube assembly (-020) per **[DIAGRAM 7a]** using 2 each 3/8 washers (b) and 2 each 3/8 nylock nuts (c). Do not tighten.

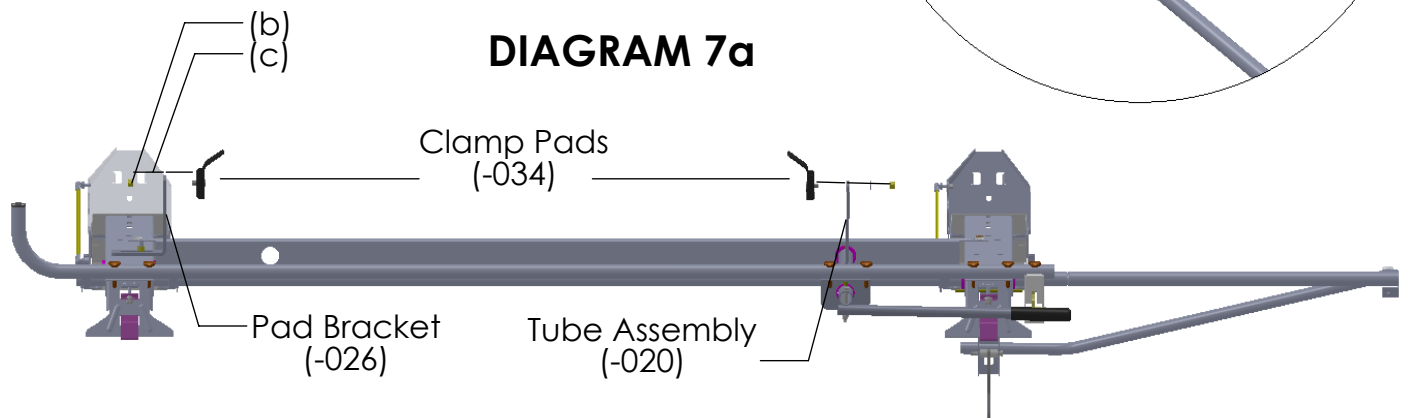

STEP 9

Now install ladder into desired position with ladder rung firmly against the clamp pads. Now adjust front pad bracket (-026) firmly against rung. It may be necessary to move pad bracket (-026) to align with one of the two square holes in the bow. Note: position pad bracket (-026) so adequate pressure is applied to ladder rung when rotating handle (-002). Ladder should be clamped firm with no movement when handle is in lock position. Tighten all hardware.

